

MONUMENT RECORD
State of Indiana - County of Monroe

Section: 05

Township: 8 North

Range: 1 East

Corner ID: Sa Cr G-05

Monument Description & Remarks: Found Railroad Spike in centerline/centerline of Lampkins Ridge Road and Cooper Road at South 1/4 corner of section.

References on file in the County Surveyor's Office: Ray Graham survey dated April 1, 1997.

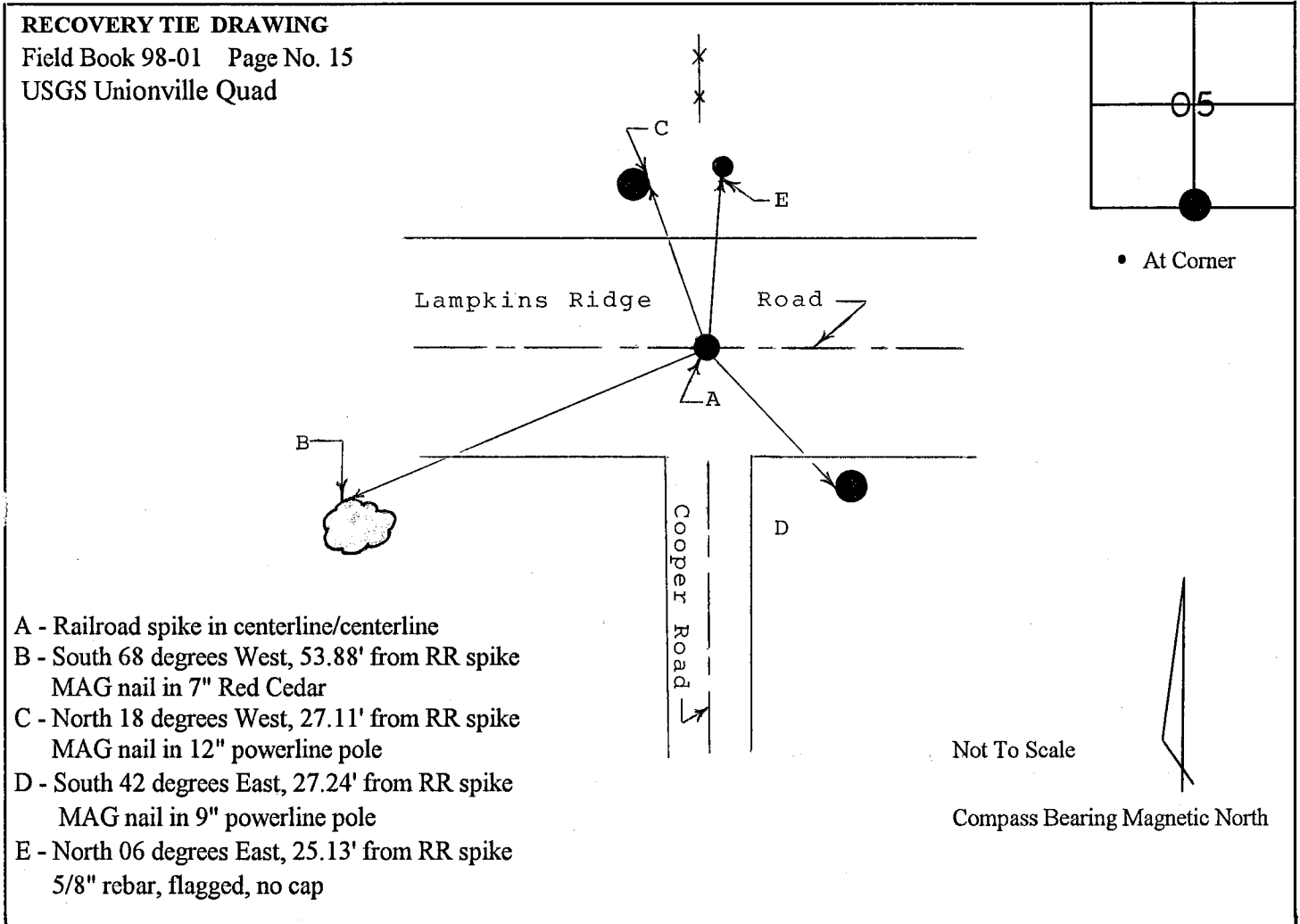

I, Kevin P. Enright, Monroe County Surveyor, hereby certify that this document was prepared under my direction in accordance with the provisions of Section 36-2-12-11 of the Indiana Code; and the above data is given under my hand and seal this 5th day of January, 1998.

Kevin P. Enright



Administered by: *Surveyor Review Board*

